

John Rodriguez

— YACHTS —

WWW.JRYACHTS.COM

John Rodriguez Yachts, Hillcrest, Rockbourne Rd, Fordingbridge, Hants, SP6 1QF, UK

Tel: +44 (0)7505 485 950 | john@jryachts.com



Vancouver 34 Pilot - SOLD

£89,950 GBP tax paid/included

United Kingdom

Huge re-fit over the last 4 years

Manufacturer/Model	Vancouver 34 Pilot - SOLD
Name	Blue J
Year	1994
Category	Sail
New or used	Used
Status	Sold
Price	£89,950 GBP
Tax/VAT status	Paid / included
Price comment	Huge re-fit over the last 4 years
Lying	Southampton, United Kingdom
Reference	V34CE17

Specifications

Length overall	10.44 m
Length waterline	8.38 m
Beam	3.20 m
Draft	1.44 m
Displacement	6,350 kg
Hull	GRP
Keel	Long keel

Description

Vancouver 34 Pilot For Sale.

Sorry, unfortunately this yacht is now SOLD.

Do you have a similar yacht for sale? If so we are always seeking quality cruising yachts for active buyers. For more details please see the [Sell Your Yacht Section](#)

For our full list of other yachts for sale please see the [Yachts for sale section](#)

Well known to us, we are pleased to have Blue J back on our books again.

A real yachtsman's yacht the Vancouver 34 Pilot's legendary seakeeping abilities combine with a deck saloon layout that gives superb views from the interior and offers great accommodation with two separate double sleeping cabins.

This extensively upgraded example has been equipped for short handed sailing and is easy to handle with her cutter rig, self tacking staysail, battened mainsail, lazyjacks and all reefing lines led aft to the cockpit.

She also has the added benefit of being fitted with a cleverly mounted C120 Raymarine Chartplotter/Radar mounted at the inside helm position. (Steering via 2nd autopilot control with steering control)

Extensively re-fitted since 2013 full details are in the specification section but her highlights include:

- Ocean 4 Man Liferaft (2016)
- Replacement standing rigging (2013)
- Replacement running rigging (2013)
- Addition of mast steps
- Replacement synthetic teak side decks (2013)
- Replacement treadmaster on coachroof (2013)
- Full cockpit tent
- Folding wheel in cockpit
- Refurbishment of interior woodwork
- New interior teak fittings and lighting
- New heads
- Additional electronics with AIS and new ICOM DSC VHF
- Vetus bow thruster
- Brunton folding prop
- Rocna Anchor (with 10mm chain)
- Yanmar 3GM30F 27HP engine with 1000 hours
- Coppercoat
- Heating

Specification

BOAT NAME: BLUE J

MAKE & MODEL: Northshore, Vancouver 34 Pilot.

YEAR: 1994

HULL MATERIAL: GRP

LENGTH OVER ALL: 10.44 metres

LENGTH OVER WATERLINE: 8.38 metres

BEAM: 3.20 metres

KEEL TYPE: Long

DRAFT: 1.44 metres

DISPLACEMENT: 6350 Kgs

ENGINE MODEL: Yanmar 3GM30F
New engine control cables (Vetus) 2015

ENGINE HP: 27 HP

ENGINE HOURS: Circa 1000 hours

SAIL DRIVE OR SHAFT DRIVE: Shaft drive

BRUNTON 17 AP5 folding Propeller 2014

FUEL TYPE: Diesel

FUEL TANKAGE: 40 gal (180L)

WATER TANKAGE: 60 gal (272L) renewed Aug 2013 HCL (DURATANK manufacture)
25 Ltr hot water tank with 220v immersion (2013)

NUMBER OF SEPARATE SLEEPING CABINS: 3

TOTAL NUMBER OF BERTHS: 5 (+1 for small child)

DOES SALOON CONVERT TO BERTH: Pilot house seats convert to 1 berth (+1 for small child)

NUMBER OF HEADS: 1x JABASCO toilet & H&C water shower replaced 2013

GALLEY AND GALLEY EQUIPMENT:

Gimballed gas cooker with 2 burners, grill & oven.

Twin SS sinks with mixer tap.

Manual pump action tap.

Fridge.

Ample stowage for crockery, cutlery, cooking utensils & food.

Crockery, cutlery & cooking utensils are included.

ENTERTAINMENT/TV/AND RADIO:

AVTEX TV multi channel & disc with HDTV-MAR14 TV antenna (2013) in Pilot House.

Small TV set mounted in Forward Cabin (2013)

SONY bluetooth radio / USB system and twin speaker in Pilot House (2013)

ELECTRONICS/VHF/INSTRUMENTS/ NAVTEX/AUTOPILOT:

RAYMARINE C120 Radar & Chartplotter. Interfaced to AIS data.

AIT 200 AIS Transponder with AIS Antenna 818-MD23-AIS (2013)

ST60+ Separate Boat Speed, Depth & Wind Speed instruments in cockpit.

Single multipurpose Speed, Depth & ST60+ Close Haul Wind Speed instrument in Pilot House.

Autohelm: RAYMARINE ST 8002 (2014) & ST6002 (2013) with control from either the cockpit or pilot house.

Stand alone GARMIN GPS 152H 230 (for DSC) (2013)

ICOM IC M423 VHF radio (2013)

NASA MARINE Clipper Navtex.

BATTERIES/ELECTRICS/SHORE POWER:

3 x heavy duty gel 12v domestic batteries (2017)

1x RB/S12 -95 ROLLS AGM 2v Engine sealed battery (2014)

MERLIN AWS 40 Amp (2014) Battery Management System including shore power interface and cable through HUBELL
16A Shore connection (2013)

Fitted with VDI-116 Galvanic Isolator (2013)

6x 220v x 12amp mains switches

Brass teak mounted interior lights, navigation lights, locker lights and cockpit security light (LED lights throughout).

Twin masthead deck lights

STERLING 12v DC3 220v AC 350W inverter (suitable for computer, 2 x USB charger + 2x cigarette 12v chargers. & 12v
plugs in pilot house & cabins.

2x waterproof 12v sockets (for spotlight or dinghy air pump etc) in Pilot House & Cockpit
BEP Marine DC Monitor
Batteries chargeable from solar panel, engine alternator and shore power.

SOLAR PANELS:

Factory fit Solar panel on pilot house roof SOLARA semi-ridged S160M.36/45 (replaced 2014)

BOW THRUSTER/FOLDING PROP/ ROPE CUTTER:

VETUS bow thrust I75 4.4Kw & tunnel installed 2014)
BRUNTON AP5 17 in 3 bladed folding propeller (2014) with AMBASSADOR rope cutter
(Spare fixed 3-bladed prop)

GROUND TACKLE AND WINDLASS:

35lb CQR anchor with 10mm chain & warp.
LOFRANS Cayman 88 electric windlass with control at the bow or in cockpit.
Kedge anchor with chain & warp.

WINCHES AND DECK EQUIPMENT:

2 LEWMAR 44ST genoa winches.
1x LEWMAR 16ST cockpit winch.
1x LEWMAR 8 reefing winch on mast
9x rope clutches.
Wheel steerage.
Compass.
SS pulpit & pushpit.
8 stanchions & bases.
2x Dorade vents + covers
WHITLOCK Cockpit compass binnacle and LEWMAR leather covered folding wheel with LEWMAR removable nut.
Stainless Steel 2 section boarding ladder. (2016)
Stainless Steel boarding platform with teak treads fitted to starboard side of transom. (2017)
3 Fabric Blue Performance hatch covers for Lewmar deck hatches. (2015)
Two sets of Washboards. 1 set Smoked acrylic – 3 sections. (2016) 1 set ply (winter use)

SAILS:

ARUN SAILS: Fully Battened mainsail with 3 rows of reefs, lazyjacks reeved mast internally and cover.
Mainsail reefing from within cockpit.
Furling yankee.
Furling Self-tacking staysail.
Storm jib (unused).
MOMENTUM "all rounder" cruising chute with launch/recovery sleeve and turtle bag (hardly used).
All sails cleaned and serviced by ARUN Sails March 2015

RIGGING AND SPARS:

Cutter rig.
SELDEN, Mast has 2 sets of spreaders.
Forestay, inner forestay & twin backstays (8 & 10mm).
Intermediate backstays.
Cap shrouds.
Fore & aft lower shrouds.
Roller reefing on forestay.
Spinnaker pole track only.
Halyards for Main, Genoa, Staysail and spinnaker.
Boom has internal reefing lines.
WALKER folding D mast steps on entire mast.
Gas strut Kicker
Complete new standing and running rigging (2013)
Plastimo headsail furling for staysail (2016)

HULL AND DECKS:

Hull antifouling builders spec original COPPER PLUS coating professionally recoated with COPPER COATING Spring 2014
Hull topsides, ALGRIP Midnight Blue coating 2011 professionally coated
Decking, TREADMASTER re-decked on coach roof (2013)

DEK-KING synthetic teak decking foredeck and side decks professionally laid by MCP (2013)

BIMMINI / TENT

Cockpit fully enclosed CJ MARINE (2013) spray hood with leather covered grab handle and integrated tent with two side and rear panel windows.

All windows fitted with removable sun cover screens as are the spray hood windows.

The side and rear panels can be either rolled up or removed allowing the top to remain in place to form a top awning.

SAFETY EQUIPMENT:

Ocean 4 Man Liferaft (2016)

2x G&R, CP 25/1 12 volt self priming bilge pumps (one in auto)

New Whale Gulper Pump

OCEAN SAFETY man-overboard horseshoe set with TREM light, MOB line recovery system, JONBUOY inflatable Danbuoy (serviced 2014)

McMURDO G4 406 GPS EPIRB (serviced 2014)

FIREBLITZ 1.5 Kg clean agent Auto-Fire extinguisher rack fitted within engine space (2013)

2 New Adult Lifejackets (2015) - Unused.

New Jackstays (2015)

General note on safety equipment: any safety equipment such as life rafts, Epirbs, fire extinguishers and flares etc. are usually personal to the current owner(s) and if being left on-board as part of the sale of a used vessel may require routine servicing, replacement, or changing to meet a new owner's specific needs.

OTHER EQUIPMENT:

EBERSPACHER heater.

OCEANAIR Yacht blinds fitted to all Pilot House windows

New electronic sensor in grey water bilge tank. (2017)

Matching 4.5 inch clock/barometer in forward cabin. (2016)

Various teak fittings include cockpit binnacle folding teak, helmsman's viewing step, Pilot House flags lockers, binocular and chart table navigation racks, cabin book racks, First Aid stowage rack, hand rails for Pilot House deckhead and bunk access, various bulkhead box racks for loose equipment stowage.

Fenders and mooring warps

Ensign staff.

Winch handles.

Set of 'V' shaped bedding for the Fore cabin.

THE VESSEL IS LYING: Southampton

Available to view by appointment

Please note all our listed yachts are privately owned and located in the owner's home port or marina. Due to the varying geographical marina locations of our yachts and the subsequent travel time and distances involved, please only make travel arrangements to view if actively considering purchase.

Office Hours Mon- Fri 09.30 – 17.30

Saturday by prior appointment

For more information or to arrange an appointment please contact John Rodriguez Yachts

Tel: +44 (0)7505 485 950

email: john@jryachts.com

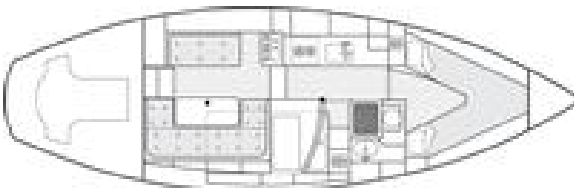





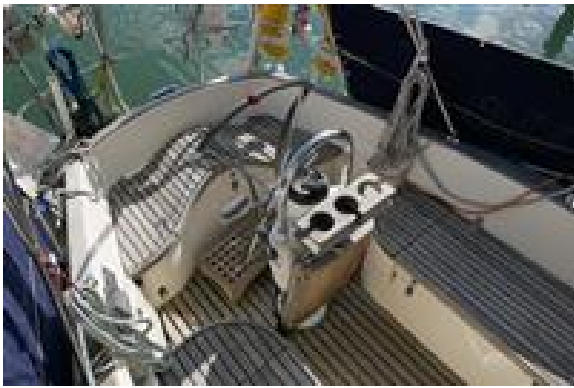





John Rodriguez Yachts provides professional ABYA yacht conveyancing & legal transfer of vessel title. The details of all vessels are offered in good faith but the correctness and accuracy of these particulars is not guaranteed and they do not constitute a part of any contract. We cannot guarantee nor warrant any vendor/third party supplied paperwork or the condition of the vessel. A buyer is strongly advised to instruct his agents, or marine surveyors, to investigate such details as the buyer desires validated. Although not mandatory in the UK we would always suggest appropriate training be undertaken before using a vessel. All vessels are offered subject to prior sale, price change, or withdrawal without notice. John Rodriguez Yachts is a trading name of John Rodriguez Yachts LLP Reg. No. OC416718 (England and Wales). Registered office C/O Connect Accounting, 15 Western Parade, Barnet, Herts, England, EN5 1AH. VAT No: 180730322. FCA FRN Number: 676493.