

John Rodriguez

— YACHTS —

WWW.JRYACHTS.COM

John Rodriguez Yachts, Hillcrest, Rockbourne Rd, Fordingbridge, Hants, SP6 1QF, UK

Tel: +44 (0)7505 485 950 | john@jryachts.com



Hallberg Rassy 36 - SOLD

£69,950 GBP tax paid/included

United Kingdom

Priced to sell

Manufacturer/Model	Hallberg Rassy 36 - SOLD
Name	Island Magic
Year	1991
Category	Sail
New or used	Used
Status	Sold
Price	£69,950 GBP
Tax/VAT status	Paid / included
Price comment	Priced to sell
Lying	Port Solent, United Kingdom
Reference	HR36IMLG

Specifications

Length overall	10.87 m
Length waterline	9.35 m
Displacement	7,500 kg
Hull	grp
Keel	Fin keel

Description

Hallberg Rassy 36 For Sale

Sorry, unfortunately this yacht is now SOLD

Do you have a similar yacht for sale? If so we are always seeking quality cruising yachts for active buyers, especially in the Solent and surrounding areas. For more details please see the [Sell Your Yacht Section](#)

For our full list of other yachts for sale please see the [Yachts for sale section](#)

The Hallberg Rassy 36 is one of the world's most iconic 36 ft cruising yachts. Highly capable and easy to sail, she has a good turn of speed and will take her owners anywhere in comfort and style.

This particular example "Island Magic" is an estate sale and is very much priced to sell. She will need some updating but she has had regular maintenance and has been in her present ownership since 2002.

As such she represents excellent value and a great way into Hallberg Rassy ownership.

Recent insurance survey available on request.

LYING: Port Solent

Available to view by appointment

Please note all our listed yachts are privately owned and located in the owner's home port or marina. Due to the varying geographical marina locations of our yachts and the subsequent travel time and distances involved, please only make travel arrangements to view if actively considering purchase.

Office Hours Mon- Fri 09.30 – 17.30
Saturday by prior appointment

For more information or to arrange an appointment please contact John Rodriguez Yachts

Tel: +44 (0)7505 485 950
email: info@jryachts.com

Specification

BOAT NAME: Island Magic

MAKE & MODEL: Hallberg-Rassy 36 1991

HULL MATERIAL: GRP

YEAR: 1991

LENGTH OVER ALL: 10.87m

LENGTH OVER WATERLINE: 9.35m

BEAM: 3.55m

DRAFT: 1.7m

KEEL TYPE: Fin Keel

DISPLACEMENT: 7,500 kg

FUEL TANKAGE: 335L

WATER TANKAGE: 310L

ENGINE MODEL: Volvo Penta MD22

ENGINE HP: 57HP

HOURS: Circa 2800

SAIL DRIVE OR SHAFT DRIVE: Shaft Drive

DATE LAST ENGINE SERVICE: 2016

AGE OF STANDING RIGGING: 2003

DATE LAST ANTIFOULED: 2017

ACCOMMODATION SUMMARY

NUMBER OF SEPARATE SLEEPING CABINS: 2

DOES SALOON CONVERT TO A DOUBLE OR SINGLE BERTH:

The backs of both seats fold up and convert to two single bunks.

TOTAL NUMBER OF BERTHS: 8

NUMBER OF HEADS: 1

GALLEY AND GALLEY EQUIPMENT:

2x Basin sink.

Fridge

2x burner gas cooker.

SPECIFICATION SECTION

SAILS:

Genoa of the roller furling type with cover

Storm Jib

Mainsail with slab reefing points and marked with sail number 66

All original however in good condition

Heavy weather jib

RIGGING AND SPARS:

Rigging 7mm, 8mm and 10mm 1x19 stainless steel shrouds with roll swaged eye toggle terminals.

Forestay

Back stay with tensioner

Two lower side stays per side

One cap shroud per side

One intermediate shroud per side

Bottlescrews are fitted at the base of each shroud all are which are fitted with split pins

Genoa sheets x 2

Genoa furling rope

Topping lift

Mainsheet

Kicking strap

Flag halyards

Halyards x 2

Mainsail halyard

Mainsail outhaul

WINCHES AND DECK EQUIPMENT:

Two self-tailing genoa winches by Lewmar

Two spinnaker sheet winches

Three halyard winches on the mast

GROUND TACKLE AND WINDLASS:

Electric Windlass

A 35lb 'CQR' type plough anchor located on the bow roller shackled to a chain approx. 70 meters of chain.

A 'Danforth' type kedge anchor is located in the lazarette locker.

PROP/ROPE CUTTER:

3 bladed Maxprop
Rope cutter

BATTERIES/ELECTRICS:
60A engine driven alternator
1x 12v Engine starter battery
2x Domestic Batteries
Battery Charger
Battery monitor BM-1
Shore power + Cable
12v sockets throughout
230v Sockets

ELECTRONICS/INSTRUMENTS/ VHF/AUTOPILOT:

Rigel steering compass with light on binnacle
Autohelm ST50 Wind & Depth, Raymarine ST60 Speed instrument above sliding hatch
Speed transducer fitted with flap valve
Raymarine ST60 Graphic instrument at chart table
Raymarine SL72 Pathfinder Plus radar with scanner on mast
Autohelm ST6000 Autopilot with linear drive
Furuno GP-31 GPS navigator
Raymarine Ray 54E DSC VHF with fistmike
Shelf for laptop computer at chart table (laptop not included)
Navigation information from a laptop can be displayed on Samsung monitor in cockpit
T-post fitted to pushpit for Navtex/GPS antennae & stern light
Insulated backstay

SAFETY EQUIPMENT:

6 Man Liferaft – service dates unknown
Horseshoe shaped lifebuoy's
Danbouy
Harness clip on eye in the cockpit
Fog horn

General note on safety equipment: Any safety equipment such as life rafts, Epirbs, fire extinguishers and flares etc. are usually personal to the current owner(s) and if being left on-board as part of the sale of a used vessel may require routine servicing, replacement, or changing to meet a new owner's specific needs.

OTHER EQUIPMENT:

Inflatable Tender
Clock
Barometer
Winch handles
Bucket, warps and fenders
Boat hook

THE VESSEL IS LYING: Port Solent

Available to view by appointment

Please note all our listed yachts are privately owned and located in the owner's home port or marina. Due to the varying geographical marina locations of our yachts and the subsequent travel time and distances involved, please only make travel arrangements to view if actively considering purchase.

Office Hours Mon- Fri 09.30 – 17.30
Saturday by prior appointment

For more information or to arrange an appointment please contact John Rodriguez Yachts

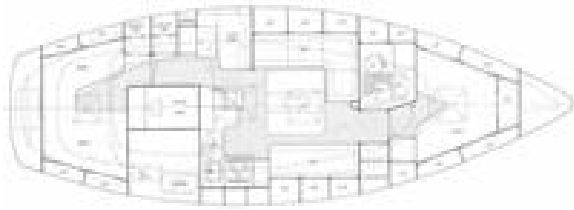







John Rodriguez Yachts provides professional ABYA yacht conveyancing & legal transfer of vessel title. The details of all vessels are offered in good faith but the correctness and accuracy of these particulars is not guaranteed and they do not constitute a part of any contract. We cannot guarantee nor warrant any vendor/third party supplied paperwork or the condition of the vessel. A buyer is strongly advised to instruct his agents, or marine surveyors, to investigate such details as the buyer desires validated. Although not mandatory in the UK we would always suggest appropriate training be undertaken before using a vessel. All vessels are offered subject to prior sale, price change, or withdrawal without notice. John Rodriguez Yachts is a trading name of John Rodriguez Yachts LLP Reg. No. OC416718 (England and Wales). Registered office C/O Connect Accounting, 15 Western Parade, Barnet, Herts, England, EN5 1AH. VAT No: 180730322. FCA FRN Number: 676493.